

Kimberly Business Center

NEW INDUSTRIAL BUILDINGS FOR SALE

6,081 - 10,672 Square Feet



1500-1578 Kimberly Avenue • Fullerton

BUILDING FEATURES:

- New High Image Business Park
- ±900 Square Feet of Office Space
- 2 Ground Level Doors
- 400 Amps 120 / 208 Volt Electrical
- 18' Warehouse Clearance
- Excellent Freeway Access to the 91 & 57 Freeways

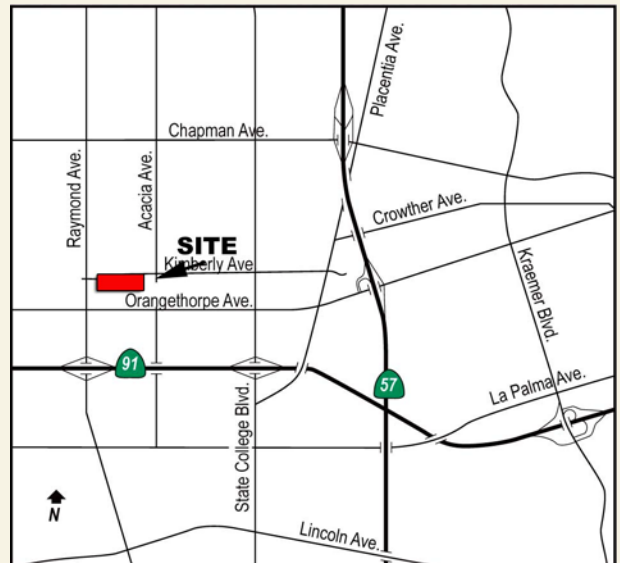

For further information, please contact:

Mitch Zehner **Louis Tomaselli**
MZehner@voitco.com LTomaselli@voitco.com

Tel 714.978.7880
Fax 714.978.8329

Another Quality Development Project By:

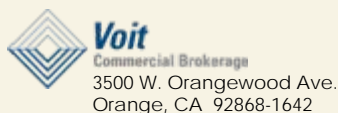

1500-1578 Kimberly Avenue • Fullerton

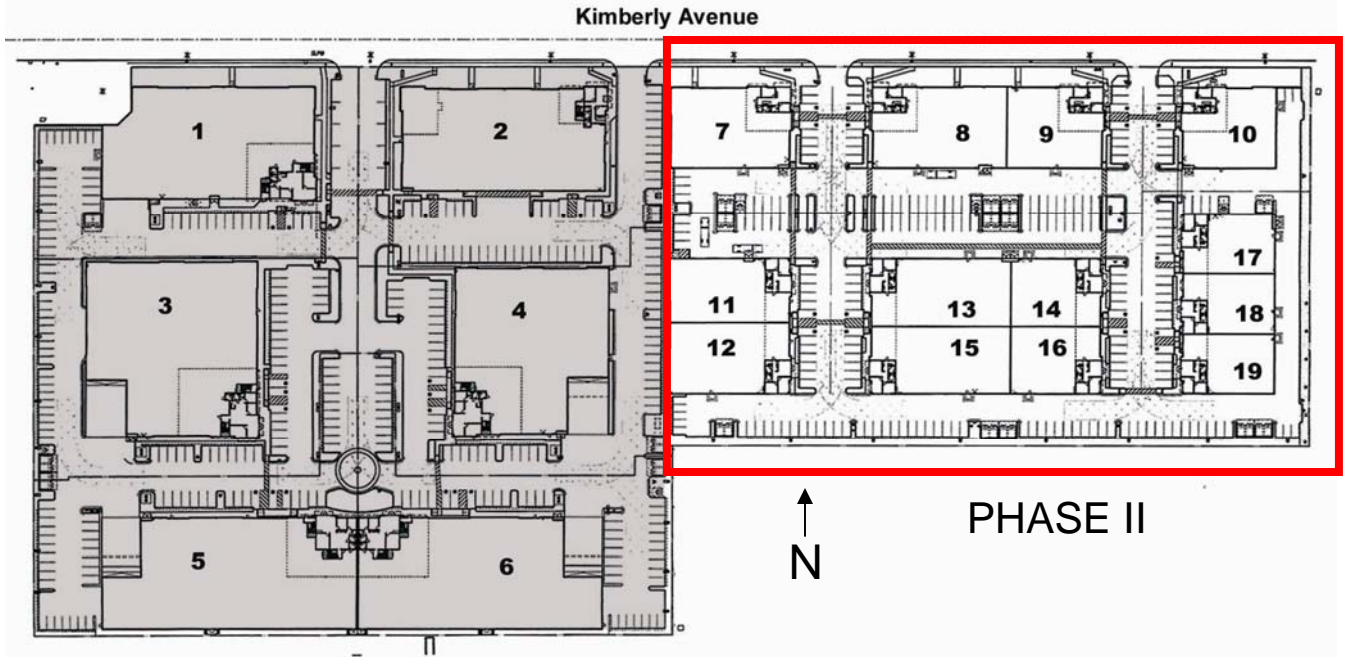

PHASE II

Bldg #	Address	Bldg Size (SF)	Office 1 st Fl (SF)	Warehouse (SF)	Parking Stalls	Warehouse Clearance	GL Loading Doors	Power (Amps/Volts)
7	1500 Kimberly	10,817	969	9,686	19	18'	2	400 A/120/208 V
8	1522 Kimberly	12,125	969	10,976	20	18'	2	400 A/120/208 V
9	1542 Kimberly	8,729	969	7,580	17	18'	2	400 A/120/208 V
10	1562 Kimberly	8,590	969	7,441	15	18'	2	400 A/120/208 V
11	1510 Kimberly	8,434	945	7,409	17	18'	2	400 A/120/208 V
12	1516 Kimberly	9,469	945	8,444	25	18'	2	400 A/120/208 V
13	1528 Kimberly	10,271	947	9,244	19	18'	2	400 A/120/208 V
14	1550 Kimberly	6,647	947	5,620	15	18'	2	400 A/120/208 V
15	1536 Kimberly	10,307	947	9,280	20	18'	2	400 A/120/208 V
16	1556 Kimberly	6,677	947	5,650	18	18'	2	400 A/120/208 V
17	1568 Kimberly	6,080	947	5,053	12	18'	2	400 A/120/208 V
18	1572 Kimberly	6,134	938	5,116	12	18'	2	400 A/120/208 V
19	1578 Kimberly	6,134	947	5,107	12	18'	2	400 A/120/208 V
		110,414						

For further information, please contact:

Another Quality Development Project By:

Mitch Zehner **Louis Tomaselli**
 MZehner@voitco.com LTomaselli@voitco.com

Tel 714.978.7880
Fax 714.978.8329

